

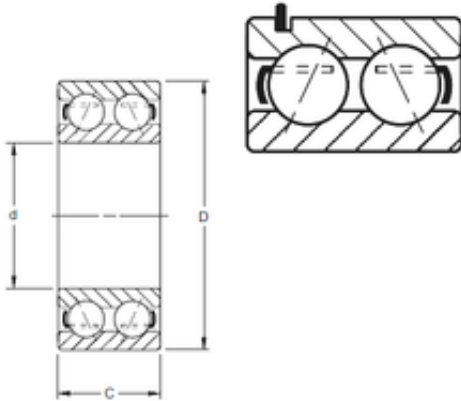

TIMKEN BEARING MFG.CORP

TIMKEN 5308WG Angular Contact Ball Bearings

Bearing No. 5308WG



5308WG Bearing 2D drawings and 3D CAD models

Size	40x90x36.53 mm
Bore Diameter	40 mm
Outer Diameter	90 mm
Width	36,53 mm
d	40 mm
D	90 mm
C	36,53 mm
Angle ()	30 °
Weight	1,102 Kg
Basic dynamic load rating (C)	90,6 kN